

# SkyTrak Installation Guide (General)

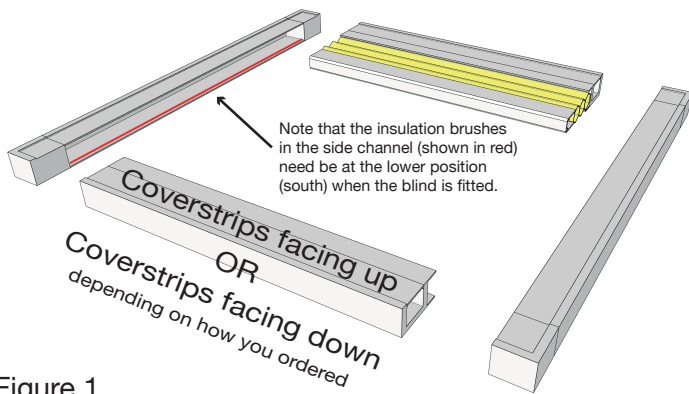

Figure 1

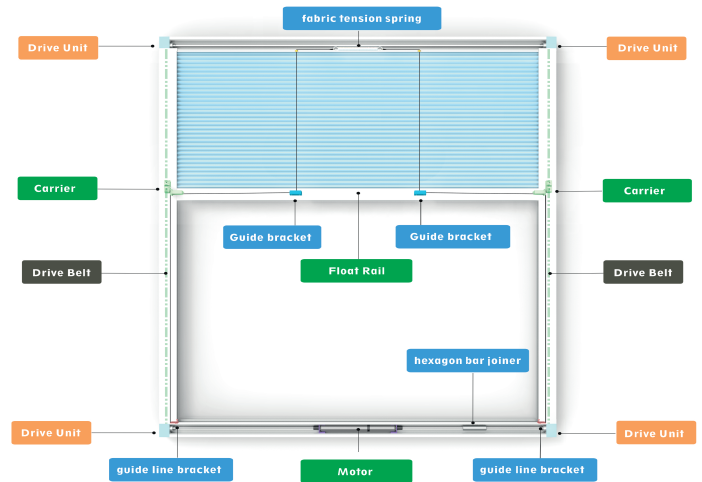

Figure 2

Carefully unpack the blind and arrange the blind on the floor as shown in figure 1.

Next, watch the video on the website (trade information page) to see how to assemble the SkyTrak ready for installation.

Figure 2 describes the parts of the blind to help you have a basic understanding on how it works.

Watching the on-site assembly video is quite important to make sure the installation goes smoothly. It's actually quite simple, and you'll only need to watch it for your first installation.

Your SkyTrak will either have 4 pre-drilled holes or 6 pre-drilled holes in the side channels. These are the only fixings that you will need to make (unless you are making a double/multi-blind installation).

You should simply side fix the blind through those holes.

The fixing does not have to be that tight, but it must be firm since it will hold the installation in place.

The most important thing is to ensure the blind is level before fixing; not for the sake of the blind's operation, but for the aesthetic look of the job.

After you've fitted blind into position, you may want to fill any gaps around the frame with caulk or silicone.

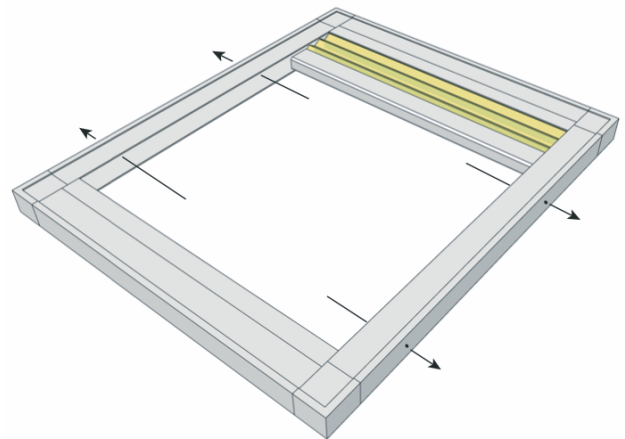

Depending on which power option you've chosen you'll need to either connect the blind to 240v, or fit the solar panel and connect it to the blind. If fitting a solar panel, simply position it somewhere where it will catch the light. Once the battery is fully charged, you can expect power to last up to four months. The solar panel simply needs to trickle charge the battery over time.

## Tips for 'one-man' installation

It's totally possible to fit SkyTrak on your own. SkyTrak is lightweight, and needs only a few fixings. Therefore, you just need to find a way to hold the blind up whilst you secure the it in place. A simple hack is to mark your 'level line' in the recess, and then hammer some thin nails into the plasterboard along this line at one end of the recess. You will then simply offer the blind up into the recess and sit it on top of the nails, whilst you make some preliminary fixings into the side channels at the other end of the blind.

## Installation using an Aluminium Shelf Kit

If you are using a shelf kit for double or multi-blind installation, we have covered the measuring and installation of SkyTrak in a separate document (available for download on the trade information page).

# SkyTrak Installation Guide (Electrics)

## Solar Panel Installation

Solar panels simply need to be plugged into the battery charging port.

The cable is approx 2.5mts long, so you could locate the solar panel in almost any position, however, it's quite wise to locate it in a position where it will collect the most light.

Whilst brackets are supplied with each solar panel,

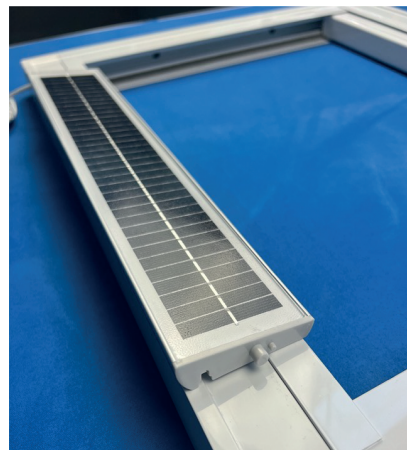

often installers find it simpler and less intrusive to sit the solar panel on top of the blind head box. If you are concerned about vibration moving the solar panel over time, then dab a blob of silicone (or double sided tape) under the solar panel to hold it in position.

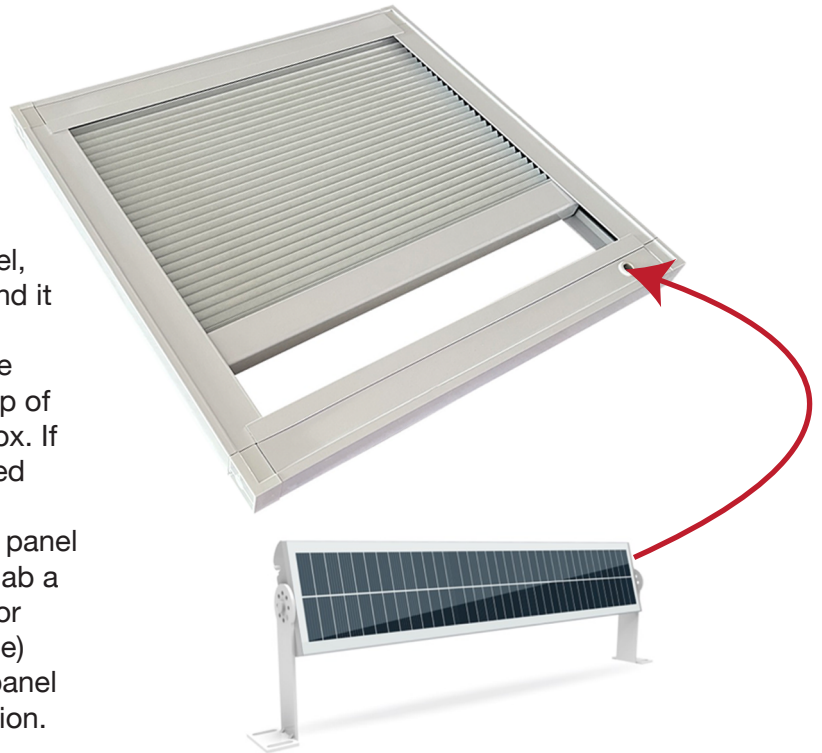

## Mains Power Installation

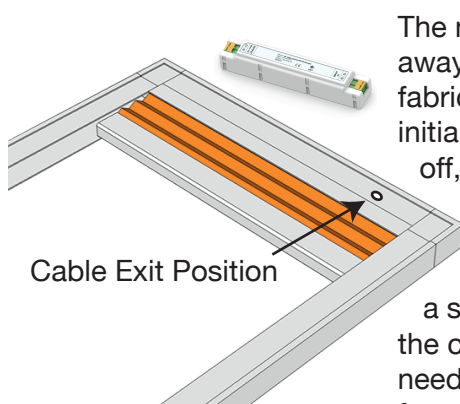

The mains transformer is hidden away in the head box at the fabric end of the blind. After the initial assembly, leave the cover off, or simply remove it if it's already fitted. To remove it, we suggest a flat blunt tool such as a filler knife rather than a screwdriver. Be sure not to bend the cover when removing it. It just needs some agitation rather than brute force to remove it.

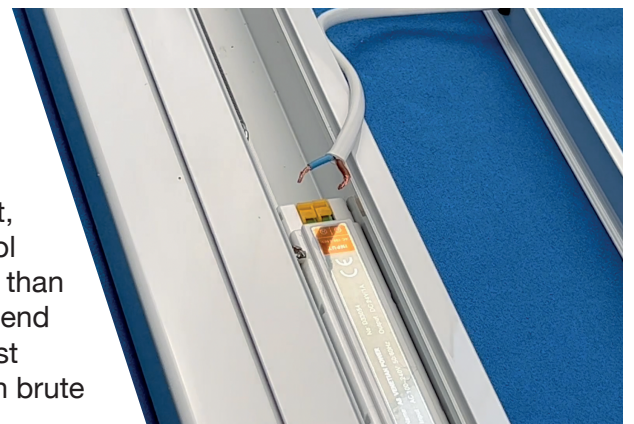

Use a flat head screwdriver to push the yellow terminal springs in the direction shown. This will open the cable hole giving you enough space to push your power cable into the port. Release the terminal springs to lock the cable in place. Fit the cover strip profile into place when done.



### **Remember:**

Your AC 240v cable goes into the INPUT side of the transformer.

The + terminal is LIVE

The - terminal is NEUTRAL

A 0.75mm twin-core flex cable is more than adequate for the installation.

The transformer is 'double insulated', it doesn't have an earth connection.